

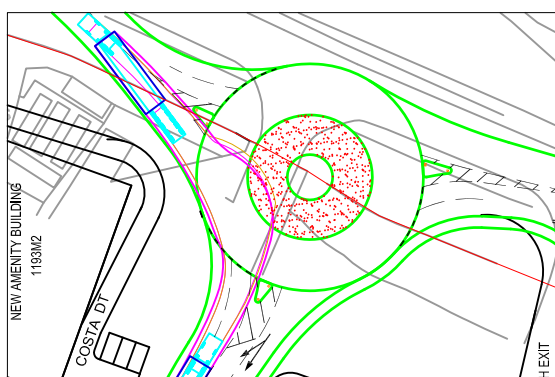

NORTH SOUTH AERIAL VIEW

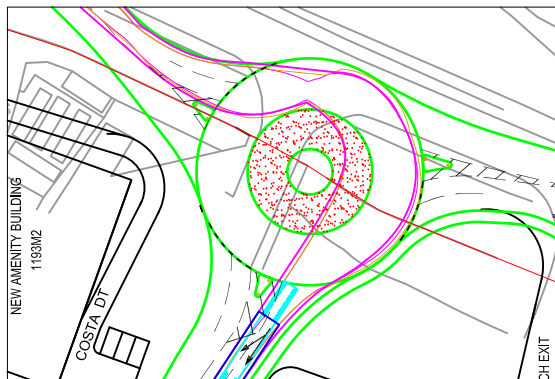

SWEPT PATH ANALYSIS - SCALE 1:1250@A3

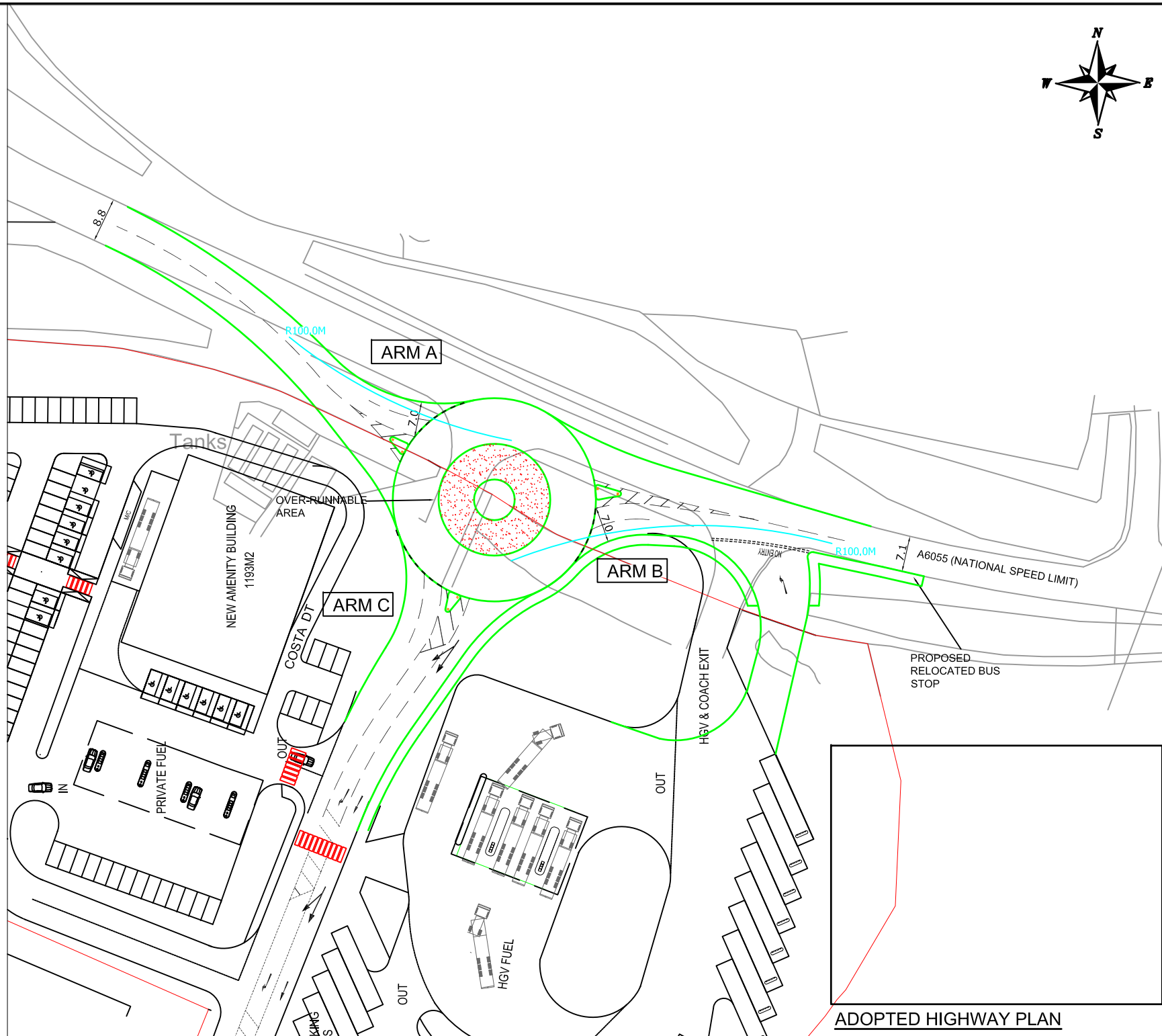
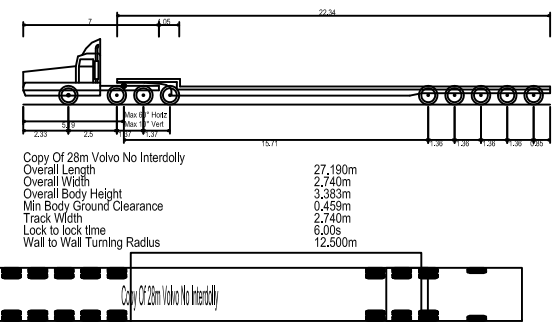

**NOTES**  
 THIS IS NOT A CONSTRUCTION DRAWING AND IS FOR INDICATIVE PURPOSES ONLY.  
 THE DRAWING WILL BE SUBJECT TO CHANGE FOLLOWING LOCAL AUTHORITY REVIEW AND CONFIRMATION OF PUBLIC HIGHWAY AND THIRD PARTY LAND BOUNDARIES.

INDICATIVE SITE BOUNDARY  
 DENOTES NEW KERBS  
 EXISTING ADOPTED HIGHWAY

LOCAL AUTHORITY: NORTH YORKSHIRE COUNCIL  
 TOTAL AREA OF SITE: 4.26Ha

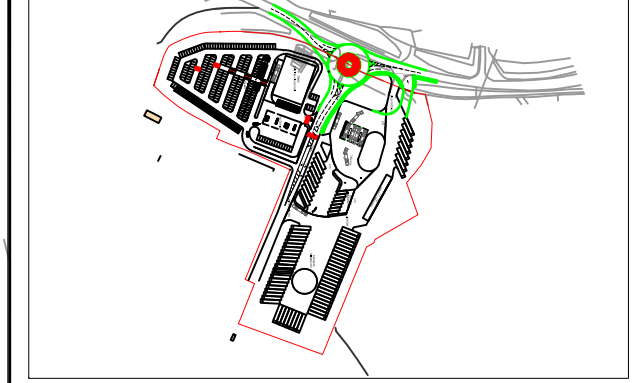

REV	DETAILS	DRAWN	CHECKED	DATE

CLIENT: **MOTO**

PROJECT: **BARTON PARK**

DRAWING TITLE: **POTENTIAL MSA SITE ACCESS PLAN**

SCALES: **1:1000 @ A3**

DRAWN: **LB** CHECKED: **MC** DATE: **MAY 22**

Croft Transport Planning & Design  
 340 Deansgate  
 Manchester  
 M3 4LY

Email: [info@crofts.co.uk](mailto:info@crofts.co.uk)  
 Tel: 0161 837 7380  
 Web: [www.eddisons.com/services/transport-planning](http://www.eddisons.com/services/transport-planning)

DRAWING NUMBER: **3393-F03** REVISION: **A**

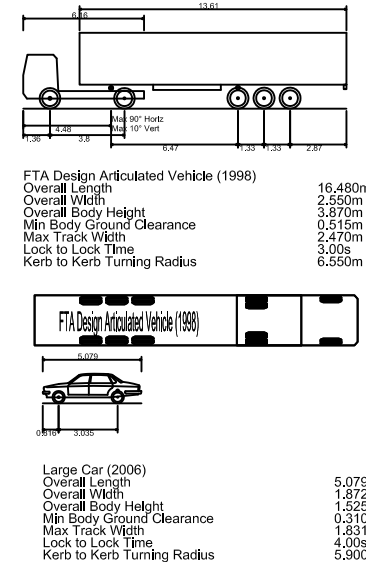
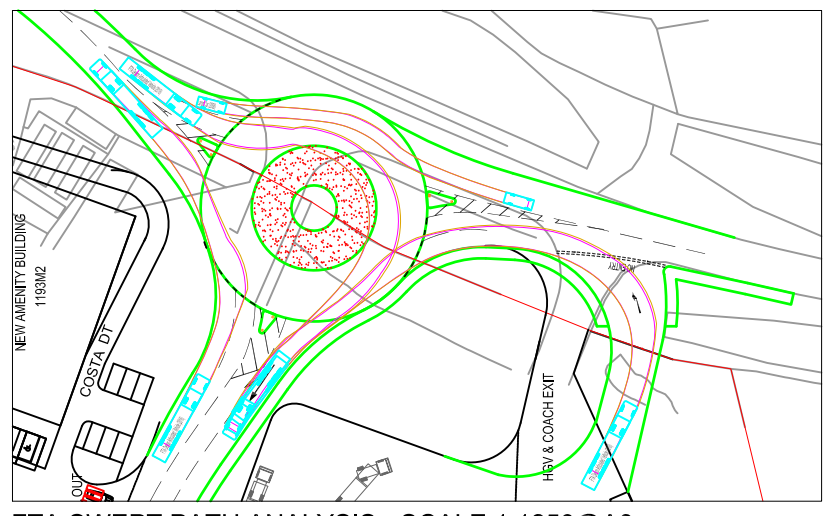

**NORMAL ROUNDABOUT DESIGN CHECKLIST - CD 116**

DESIGN FEATURE	DESIGN REQUIREMENTS	ARM A	ARM B	ARM C	NOTES
EFFECTIVE ENTRY WIDTH (e)-KERB TO MARKING	3-4.5M, 3-3.5M APPROPRIATE AT MULTILANE ENTRIES	7.0m	7.0m	7.0m	COMPLIES
TOTAL ENTRY WIDTH (Te)-KERB TO KERB	3 - 10.5M (SINGLE CW) 7.3 - 15M (DUAL CW)	9.0m	9.0m	9.0m	COMPLIES
ENTRY RADIUS (r)	10 - 100M (20M IDEAL)	30m	20m	25m	COMPLIES
ICD (D)	28M MIN	40m	40m	40m	COMPLIES
ENTRY PATH CURVATURE (DEFLECTION)	NO GREATER THAN 100M RADIUS	100m	100m	NA	COMPLIES
CIRCULATORY CARRIAGEWAY	1.0 - 1.2 X MAX. KERBED ENTRY WIDTH	9.0m	9.0m	9.0m	COMPLIES
EXIT RADIUS	15M - 100M (40M IDEAL)	40m	100m	40m	COMPLIES
EXIT WIDTH	SPIRAL TO TOTAL ENTRY WIDTH OR SINGLE CARRIAGEWAY TWO-LANE DUAL CARRIAGEWAY 10-14M (LONG SPATTER PLANS USED)	7.5m	8.0m	7.5m	COMPLIES

ROUNDABOUT GEOMETRY